

NOTES:

1. FINISH: ALOCROM 1200 AND POWDER COAT MATT BLACK OR RAYMARINE APPROVED EQUIVALENT.
2. THIS DRAWING, SUPPLIED IN ELECTRONIC FORMAT AS 3036441B.PDF IS THE 'MASTER DOCUMENT'. DXF DATA AVAILABLE ON REQUEST, MUST BE VERIFIED TO THE MASTER SUPPLIED. LAST 3D DATA SUPPLIED: 3036441B.STP
3. REFER TO 3D MODEL FOR UNSPECIFIED DIMENSIONS.
4. PARTS TO BE SUPPLIED CLEAN AND BURR FREE.
5. TOOLING FEATURES TO BE AGREED BY RAYMARINE.

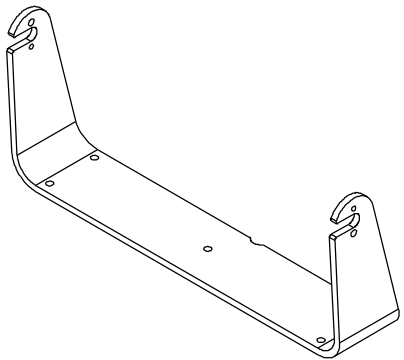

ISOMETRIC VIEW
SCALE 1:3

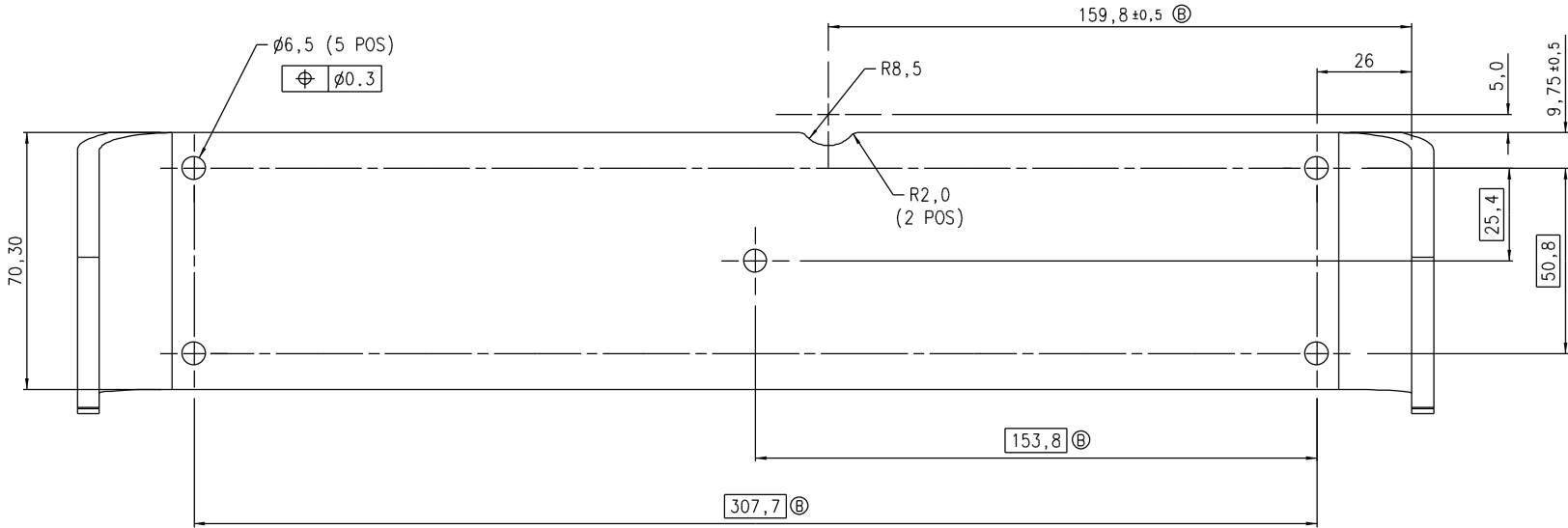
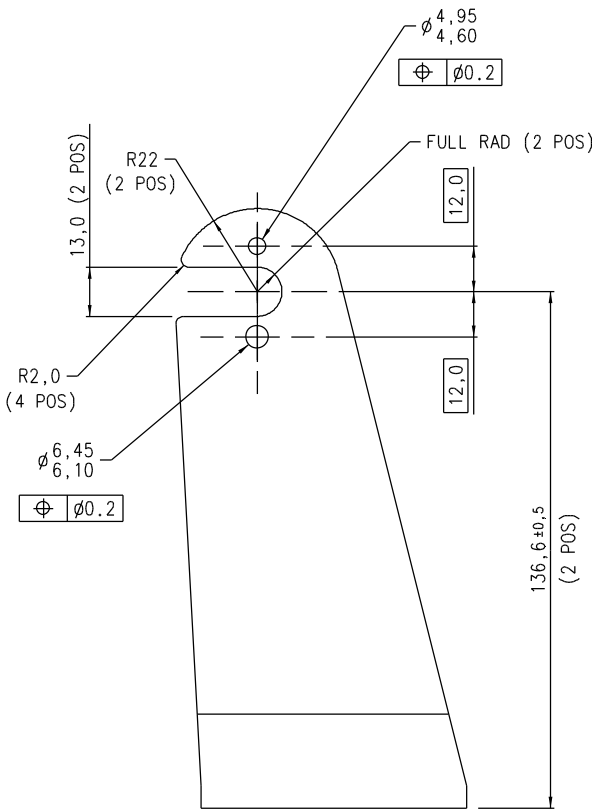
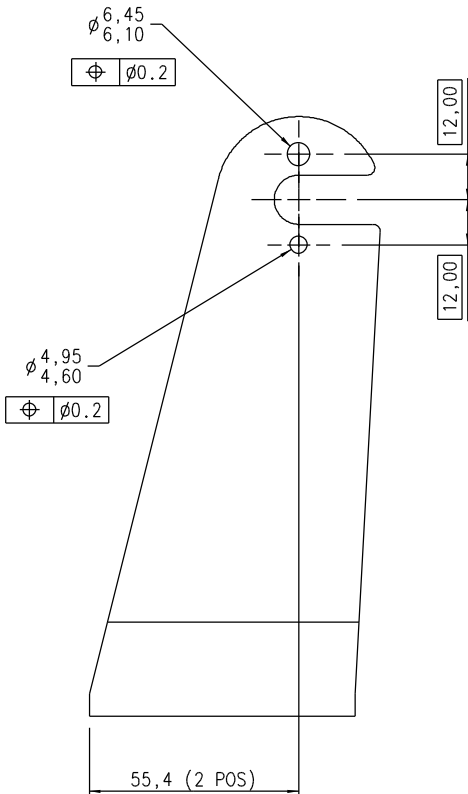

ITEM No	DRG/PART No	QTY	DESCRIPTION
PARTS LIST			



THE INFORMATION CONTAINED HEREIN SHALL NOT BE REPRODUCED WITHOUT THE PRIOR WRITTEN PERMISSION OF RAYMARINE LTD

TOLERANCES UNLESS OTHERWISE STATED
X $\pm 0,50$
-X $\pm 0,25$
-XX $\pm 0,10$
-XXX $\pm 0,05$
ANGLES $\pm 1^\circ$ (EXCL DRAFT)
DIMENSIONS IN MM

MACHINING: SURFACE 1,6/ SHARP INTERNAL CORNERS TO HAVE RADIUS 0,4 MAX DEBURR ALL EDGES
SCALE: 1:2

DRAWN TO BS308 DO NOT SCALE - IF IN DOUBT ASK MATERIAL ALUMINIUM ALLOY 5251-H22, 6mm THICK FINISH SEE NOTES
DR'N: AJE DATE: 11/10/07 CK'D: A.J.C APP'D:

B	359,7 WAS 362,7 (D4), 159,8 WAS 161,4 (B5), 153,8 WAS 155,4 (C5), 307,7 WAS 310,7 (C4).	R.S/a.c 02.12.07
A	FIRST ISSUE	ORIGINAL
ISS	DESCRIPTION OF CHANGE	DATE
TITLE BRACKET,TRUNION, C120W		
DRAWING No. 3036-441		A 1
SHT 1 OF 1		