

NOTES:

1. FINISH: ALOCROM 1200 AND POWDER COAT MATT BLACK OR RAYMARINE APPROVED EQUIVALENT.
2. THIS DRAWING, SUPPLIED IN ELECTRONIC FORMAT AS 3036442B.PDF IS THE 'MASTER DOCUMENT'. DXF DATA AVAILABLE ON REQUEST, MUST BE VERIFIED TO THE MASTER SUPPLIED. LAST 3D DATA SUPPLIED: 3036442B.STP
3. REFER TO 3D MODEL FOR UNSPECIFIED DIMENSIONS.
4. PARTS TO BE SUPPLIED CLEAN AND BURR FREE.
5. TOOLING FEATURES TO BE AGREED BY RAYMARINE.

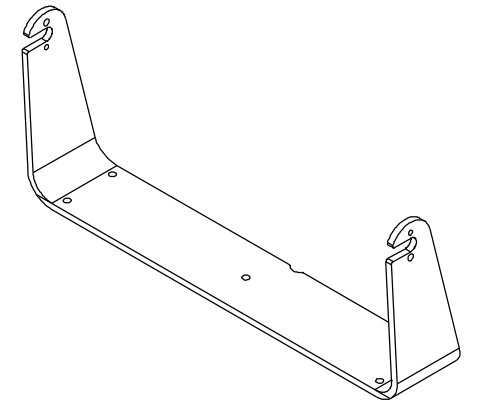

ISOMETRIC VIEW
SCALE 1:3

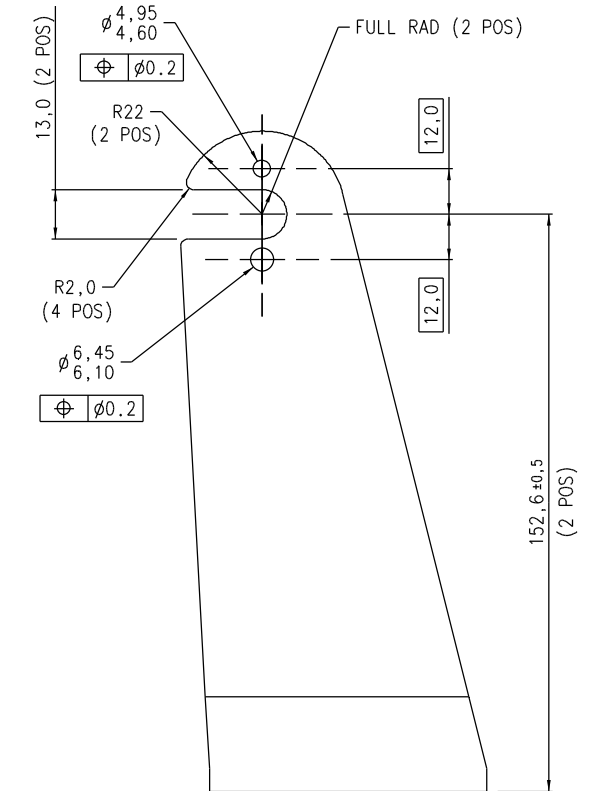
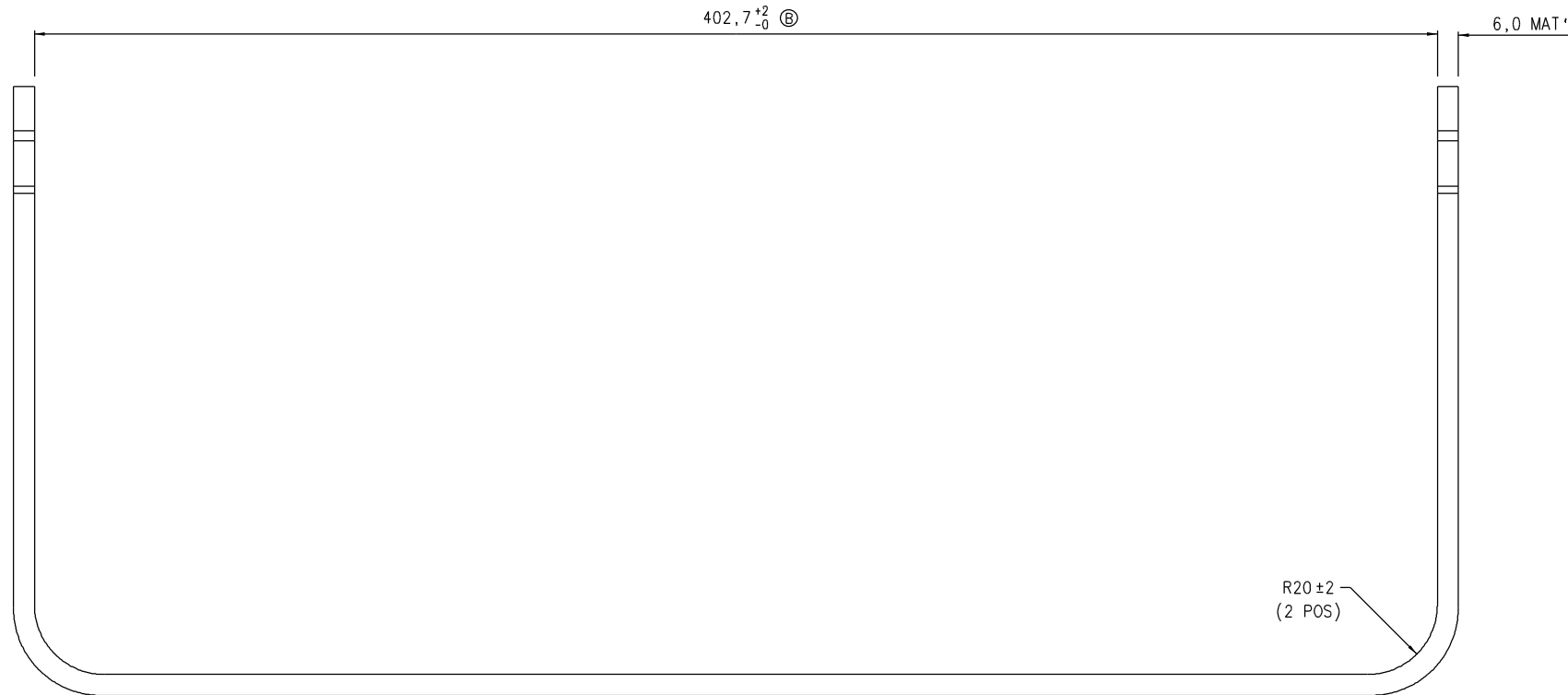
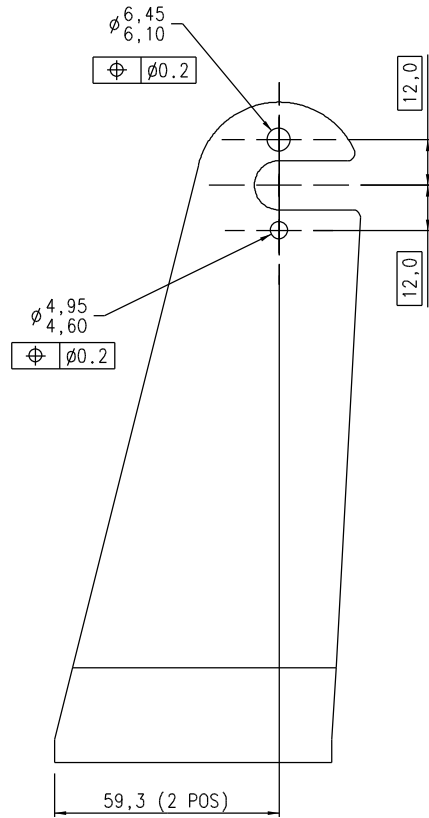
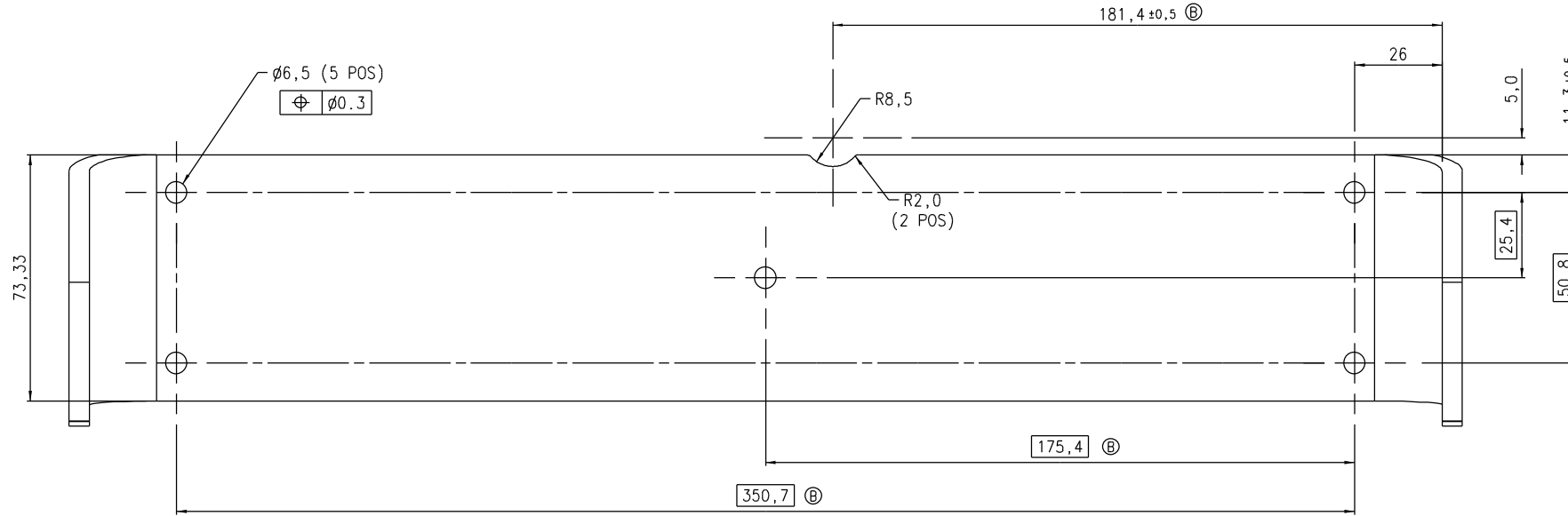

ITEM No	DRG/PART No	QTY	DESCRIPTION
PARTS LIST			
1			
2			



THE INFORMATION CONTAINED HEREIN SHALL NOT BE REPRODUCED WITHOUT THE PRIOR WRITTEN PERMISSION OF RAYMARINE LTD

TOLERANCES UNLESS OTHERWISE STATED	MACHINING:	FINISH
X ±0.50	SURFACE 1/8	SEE NOTES
.X ±0.25	SHARP INTERNAL CORNERS TO HAVE RADIUS 0.4 MAX (EXCL DRAFT)	
.XX ±0.10		
.XXX ±0.05		
ANGLES ±1°		
DIMENSIONS IN MM	SCALE: 1:1	

DRAWN TO BS308 DO NOT SCALE - IF IN DOUBT ASK
MATERIAL ALUMINIUM ALLOY 5251 H22, 6mm THICK
FINISH SEE NOTES

B	402.7 WAS 405.7 (D5), 181.4 WAS 182.8 (A6), 175.4 WAS 177.0 (C5), 350.7 WAS 354.0 (C5).	R.S/v.a.c. 02.12.07
A	FIRST ISSUE	ORIGINAL
ISS	DESCRIPTION OF CHANGE	DATE
TITLE BRACKET, TRUNION, C140W		
DRAWING No. 3036-442		A
SHT 1 OF 1		1